

PROPOSED G+II STORIED (9.75 M.) RESIDENTIAL & G+II STORIED(10.95 M.) ASSEMBLY PLAN AT MOUZA - JAGADDAL, J.L. NO.-71, L.R. DAG NOS.-1320 & 1321, L.R. KHATIAN NOS.-2712 & 2724, HOLDING NO. - 1646, DWARIR ROAD, WARD NO. - 25, P.S.- SONARPUR, DISTRICT:- SOUTH 24 PARGANAS, KOLKATA - 700151

NAME OF OWNER-

- 1) SRI SUDARSHAN DAS MUNDHRA
- 2) SRI RAGHAV DAS MUNDHRA

NAME OF DEVELOPER-

MULTILINE REALTY

SCALE - 1:400

LAND AREA (AS PER DEED) = 4698.4 Sqm (70 Ka - 3 Ch -38.58 Sqft.)

LAND AREA (AS PER PHYSICAL) = 4698.399 Sqm (70 Ka - 3 Ch - 38.57 Sqft)

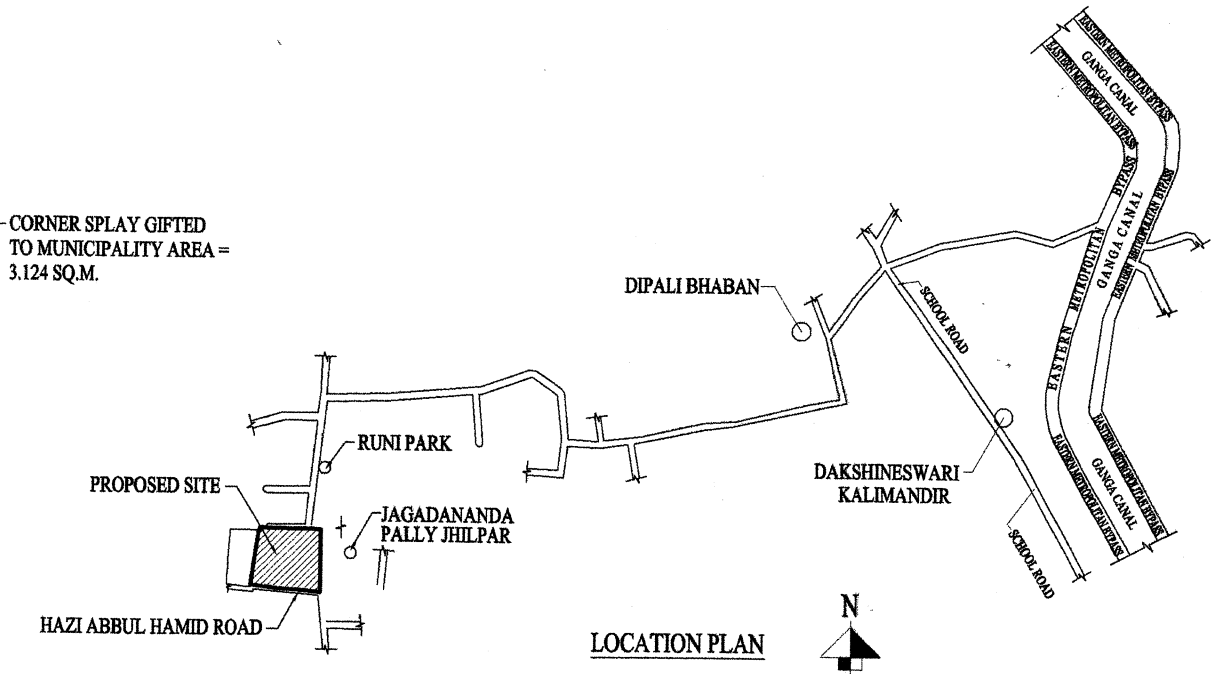
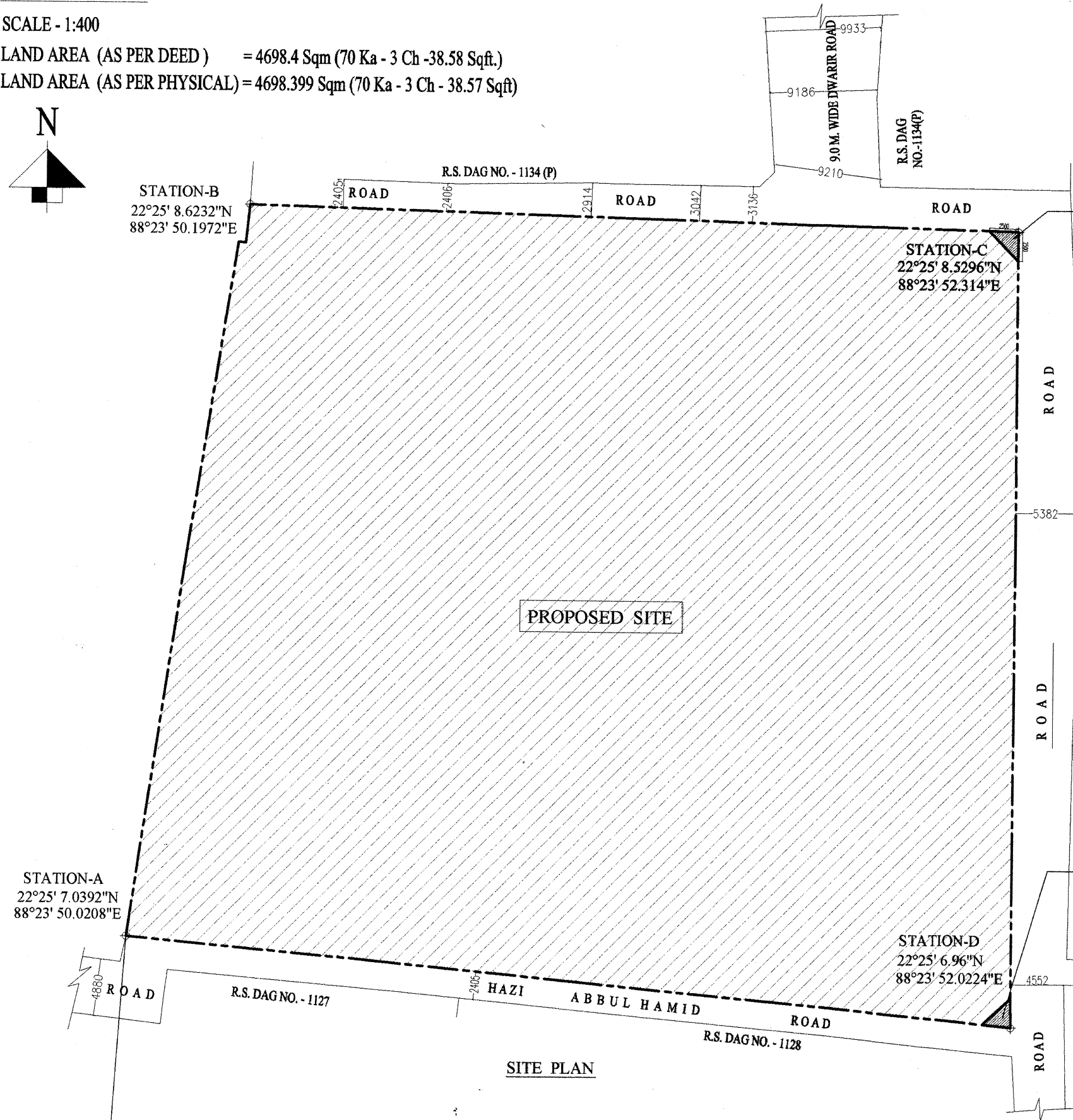
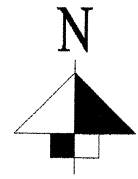

PROPOSED SITE

LOCATION PLAN

SITE PLAN

SIGNATURE OF OWNER

Raj Kumar Agarwal

Rajkumar Agarwal
Architect
Member of Council of
Architecture CA / 94 / 17940

SIGNATURE OF ARCHITECT

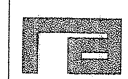

RAJ AGRAWAL & ASSOCIATES
8B, ROYD STREET, KOLKATA - 16